

abbotFox



Yarmouth Road, Norwich
£825 PCM

“

We are a team of genuine individuals who hold a deep passion for both property and marketing. Collectively, we bring over 70 years of experience in the property market of Norfolk and Suffolk. Our affection for both counties runs deep, and we are enthusiastic about sharing our passion with you.

Colin McKenzie | **Branch Partner**







THE DETAIL _____

This spacious one bedroom Bungalow is located in the popular suburb of Thorpe St Andrew and offers a spacious lounge, fitted kitchen, bathroom, double bedroom and small garden area.

Thorpe St Andrew is situated to the east of Norwich and is serviced by numerous local amenities, including shops, schools, doctors and dentist surgeries. There are regular bus services into the city centre with Norwich train station providing daily services to Cambridge and London approximately 2 miles away.

THE HIGHLIGHTS _____

- Recently fully renovated
- Spacious One Bedroom Bungalow
- Envidable Location
- Bathroom
- Kitchen
- Lounge
- Small Garden Area

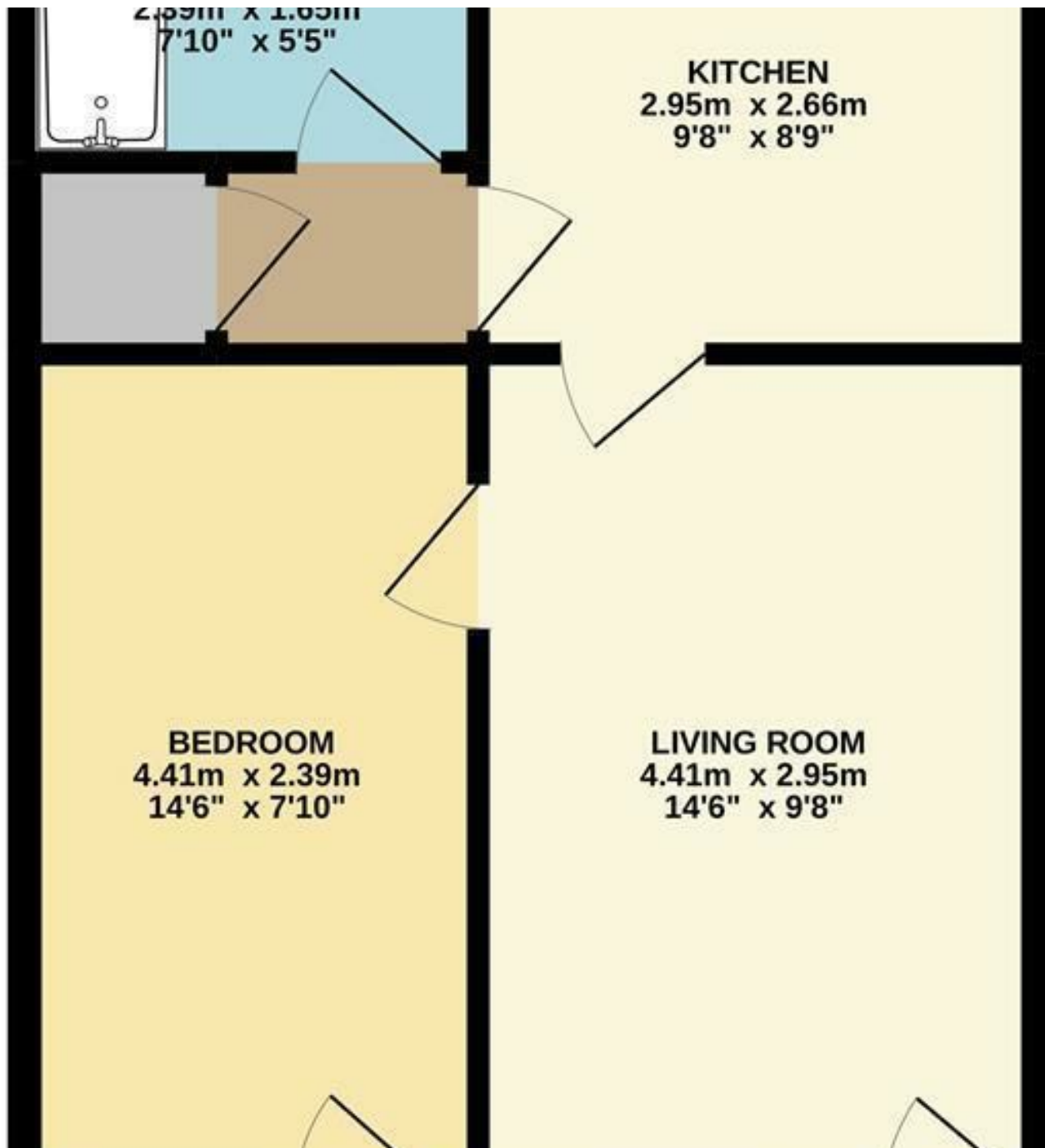

Let's talk

01603 660000

sales@abbotfox.co.uk

@abbotfox

EPC RATING -

Disclaimer – In accordance with the Property Misdescriptions Act, the company abbotFox gives notice that all descriptions, references to condition, necessary permissions for use and other details are given in good faith and believed to be correct, but any purchaser should not rely on them as statements of fact, and must satisfy themselves by inspection or other means, as to their accuracy.